



NAMMA FAMILY
BUILDER & DEVELOPER PVT.LTD.



@ ILLALUR | THIRUPORUR

RESIDENTIAL | COMMERCIAL | INVESTMENT

RESIDE IN STYLE
AMONGST SOOTHING
GREENS

NAMMA FAMILY BUILDER & DEVELOPER PVT.LTD.



ABOUT US

"NAMMA FAMILY BUILDER & DEVELOPER" was established in 2016 by MR.PONNUSAMY KARTHIKA (Founder & Chairman). Namma Family Builder & Developer Pvt.Ltd, The best builder in Guduvanchery, Chennai. We are determined on providing such a pleasure to clients by corporal establishments. The company had grown to a stage of handling multiple projects at a time.

Subsequently, it was converted into a "NAMMA FAMILY BUILDER & DEVELOPER PVT. LTD", in the year 2020. Thus establishing "NAMMA FAMILY BUILDER & DEVELOPER" as one of the most revered builder & developer in Chennai.

Successfully completed above 1050+ (Resale Plots, Layout Plots, Commercial Plots, Industrial Plots) projects across Chennai in an effective and successful manner. Now, we extended our service in LAYOUT SALES & we are channelizing our best efforts to make an impact in layout sales & reached top in Real Estate.

With all Projects Being Completely Customer-centric, NFBP Pvt. Ltd. Believes In Ensuring That Projects are Developed to Serve The Needs of Their Customers & Meet their Satisfaction.

Our Aim Is to Continue the legacy of Being one of the Best Builders in Chennai. We strive to exhibit the concept of RESALE on Plots & LAYOUT Sale across Guduvanchery, Maraimalainagar, ECR, OMR & GST. Apart from this we also Becoming Dominant Player In CONSTRUCTION services.

Why Us ?

- » Namma Family Builder & Developer, Private Limited அங்கிகாரம் பெற்ற நிறுவனம்.
- » நம்முடைய பலமே (NFBP Pvt.Ltd.) Multiple Sizes, Multiple Plots & Multiple Location with best client service.
- » உங்கள் குடும்ப ஏதிகாலத்திற்கு ஏற்ற Property ஏது என்று நம் நிறுவனமே உங்களுக்கு Guide செய்யும் மற்றும் Customized Construction நல்ல முறையில் செய்து கொடுக்கப்படும்.
- » இப்பவும் எப்பவும் உங்களுக்கு NFBP Pvt.Ltd.-யில் இருந்து முழு Support & Guidance கிடைக்கும்.



Namma Family Builder & Developer Pvt.Ltd.



GOVERNMENT OF INDIA
MINISTRY OF CORPORATE AFFAIRS
Central Registration Centre

Certificate of Incorporation

[Pursuant to sub-section (2) of section 7 and sub-section (1) of section 8 of the Companies Act, 2013 (18 of 2013) and rule 18 of the Companies (Incorporation) Rules, 2014]

I hereby certify that NAMMA FAMILY BUILDER & DEVELOPER PRIVATE LIMITED is incorporated on this Seventh day of November Two thousand twenty under the Companies Act, 2013 (18 of 2013) and that the company is limited by shares.

The Corporate Identity Number of the company is U70109TN2020PTC139285.

The Permanent Account Number (PAN) of the company is AAHCN2787P

The Tax Deduction and Collection Account Number (TAN) of the company is CHEN12128E

Given under my hand at Madras: this Seventh day of November Two thousand twenty.

Digital Signature Certificate
Mr. ARVIND KUMAR BUNKAR
Deputy Registrar Of Companies
For and on behalf of the Jurisdictional Registrar of Companies
Registrar of Companies
Central Registration Centre

Disclaimer: This certificate only evidences incorporation of the company on the basis of documents and declarations of the applicant(s). This certificate is neither a license nor permission to conduct business or collect deposits or funds from public. Permission of sector regulator is necessary wherever required. Registration status and other details of the company can be verified on www.mca.gov.in

Mailing Address as per record available in Registrar of Companies office:
NAMMA FAMILY BUILDER & DEVELOPER PRIVATE LIMITED
NO.11,1ST STREET,VALLI NAGAR,NANDHIVARAM,
GUDUVANCHERY, KANCHIPURAM, Kancheepuram, Tamil Nadu, India,
603202

* as issued by the Income Tax Department



Certificate

This is to Certify that
**NAMMA FAMILY BUILDER &
DEVELOPER PRIVATE LIMITED**
No. 11, 1st Street, Valli Nagar, Nandhivaram, Guduvanchery,
Kanchipuram, Tamil Nadu - 603202, India.

has been found in Compliance with requirements of
Quality Management System
ISO 9001:2015
for the following scope:

Purchase, Sell of any Movable or Immovable Property including Industrial,
Commercial, Residential or Farm Lands, Plots, Buildings,
Houses, Apartments and Flats

Certificate No. QMS/025497/1221
Original Certificate Date: 28-December-2021
Issue Date: 28-December-2021
Expiry Date: 27-December-2024

To check this certificate status visit:
<http://naam.fmb.com/certificate/organization.html>



REASONS TO INVEST IN REAL ESTATE

- Steady Cash Flow (value increases over time)
- Safe investment with Great Returns
- Long-Term Security
- Tax Advantages
- Passive Income
- Thrives along with a booming economy

UNIQUE SERVICES IN CONSTRUCTION

Architectural Designs | Floor Plans
3d Views | 3d Walkthroughs | Virtual Tours

EC, PATTA, CHITTA, ADANGAL,
FMB, A-REGISTER **FREE!!!**
GET **FREE** PLANS, 3D VIDEOS &
VIRTUAL TOUR FOR YOUR HOME

NFBD REVENUE DOCUMENT VERIFICATION PROCESS

- ✓ Documents Legal verification by Lawyer
- ✓ VAO legal check
- ✓ FMB, A-Register, Chitta, Adangal, Patta Process
- ✓ DTCP Apply Process
- ✓ Manual & Online EC Apply
- ✓ Subdivision & Name Transfer Patta Process
- ✓ Regularisation & Subdivision process

WHY CLIENTS BOUGHT PROPERTY WITH US? SERVICES WE OFFER

- ✓ Decades of Experience with Transparent Deal
- ✓ Personalized Site Visits
- ✓ Leading Advocate Opinion
- ✓ Easy Bank Loan & Registration on Time
- ✓ Keeping Promises with 24/7 Client Service
- ✓ A to Z Registration Process with Full Support
- ✓ Best Architectural Design
- ✓ Timely Completion
- ✓ Post Sale Assistance





PREMIUM LAYOUT FOR RESIDENTIAL | COMMERCIAL | INVESTMENT PURPOSE



**GO
GREEN**

**CHOOSE GREEN
LIVE GREEN**

BE PART OF A GREEN DEVELOPMENT



NAMMA FAMILY BUILDER & DEVELOPER PVT. LTD.



@ ILLALUR | THIRUPORUR

AREA STATEMENT

Plot No.	SQ.FT.
Plot No: 1	2462
Plot No: 2	1349
Plot No: 3	1535
Plot No: 4	861
Plot No: 5	873
Plot No: 6	861
Plot No: 7	880
Plot No: 8	880
Plot No: 9	880
Plot No: 10	880
Plot No: 11	880
Plot No: 12	830
Plot No: 13	742
Plot No: 14	800
Plot No: 15	800
Plot No: 16	800
Plot No: 17	800
Plot No: 18	800
Plot No: 19	981
Plot No: 20	986
Plot No: 21	981
Plot No: 22	813
Plot No: 23	809
Plot No: 24	804
Plot No: 25	703

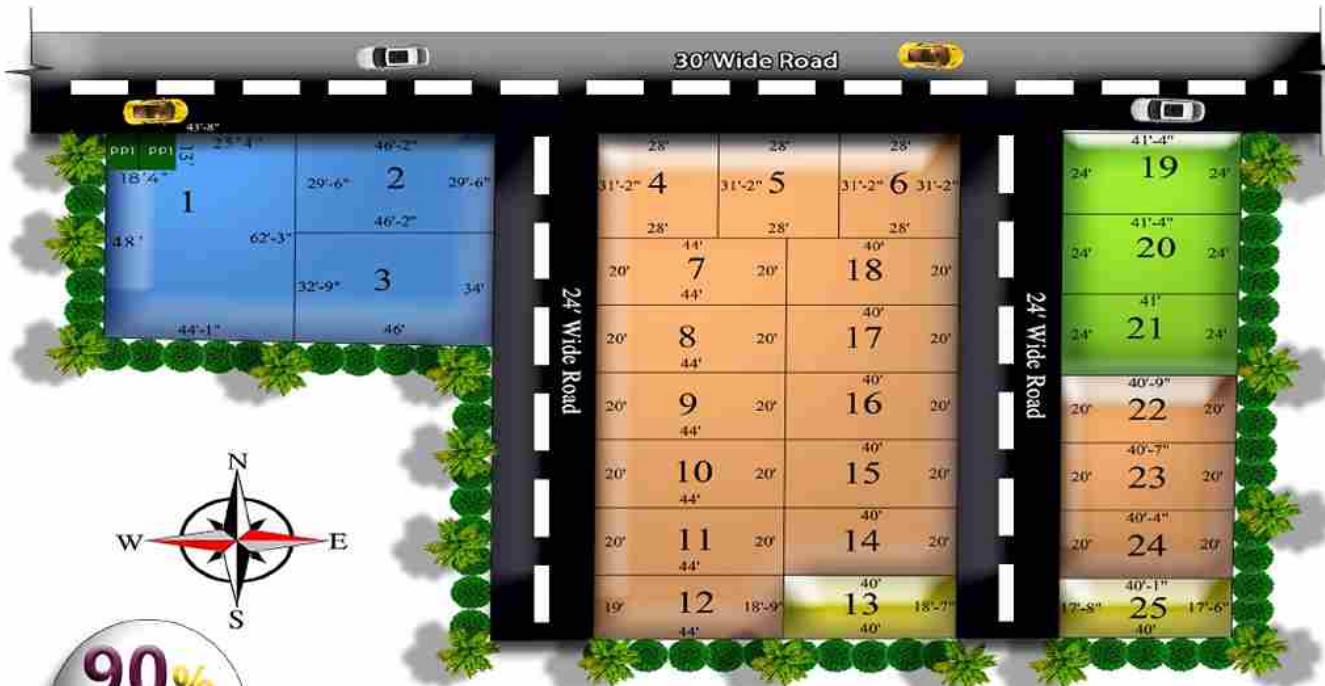

SIZE RANGE

- Below 800
- 800 to 900
- 901 to 1000
- 1001 to 2500



DTCP No. 42/2021



Head Office
No.11 Valli Nagar 1st Street,
Govindarajapuram, Guduvanchery - 603-202.

Branch Office
GST ROAD : No.88, Rajaji Nagar,
Thangappapuram, Guduvanchery-603-202.

Branch Office
OMR ROAD : No.1/35, OMR Road,
Kelambakkam, Thiruporur - 603 103

Namma Family Builder & Developer Pvt.Ltd.

Project Highlights & Features

- ✓ 100% Legal Clear | 100% Vastu
- ✓ Secured Gated Community | Fully compounded
- ✓ Well laid Black Top Roads – 24' , 30' | Potable Ground water
- ✓ Ready to Build | Minimum to Maximum Sq.Ft.
- ✓ Easy access to schools, colleges, hospitals, supermarket, IT companies with easy transportation facilities

Site Advantages

- ✓ 10 Minutes to Srivani Vidyalaya Matriculation School
- ✓ 10 Minutes to Bharatha Vidyalaya Mat.Higher Sec.School
- ✓ 10 Minutes to Thiruporur Bus Stand
- ✓ Near to Thiruporur SRO
- ✓ 15 Minutes to SIDCO
- ✓ Near to Shri Sathya Sai Hospital
- ✓ 25 Minutes to One Hub

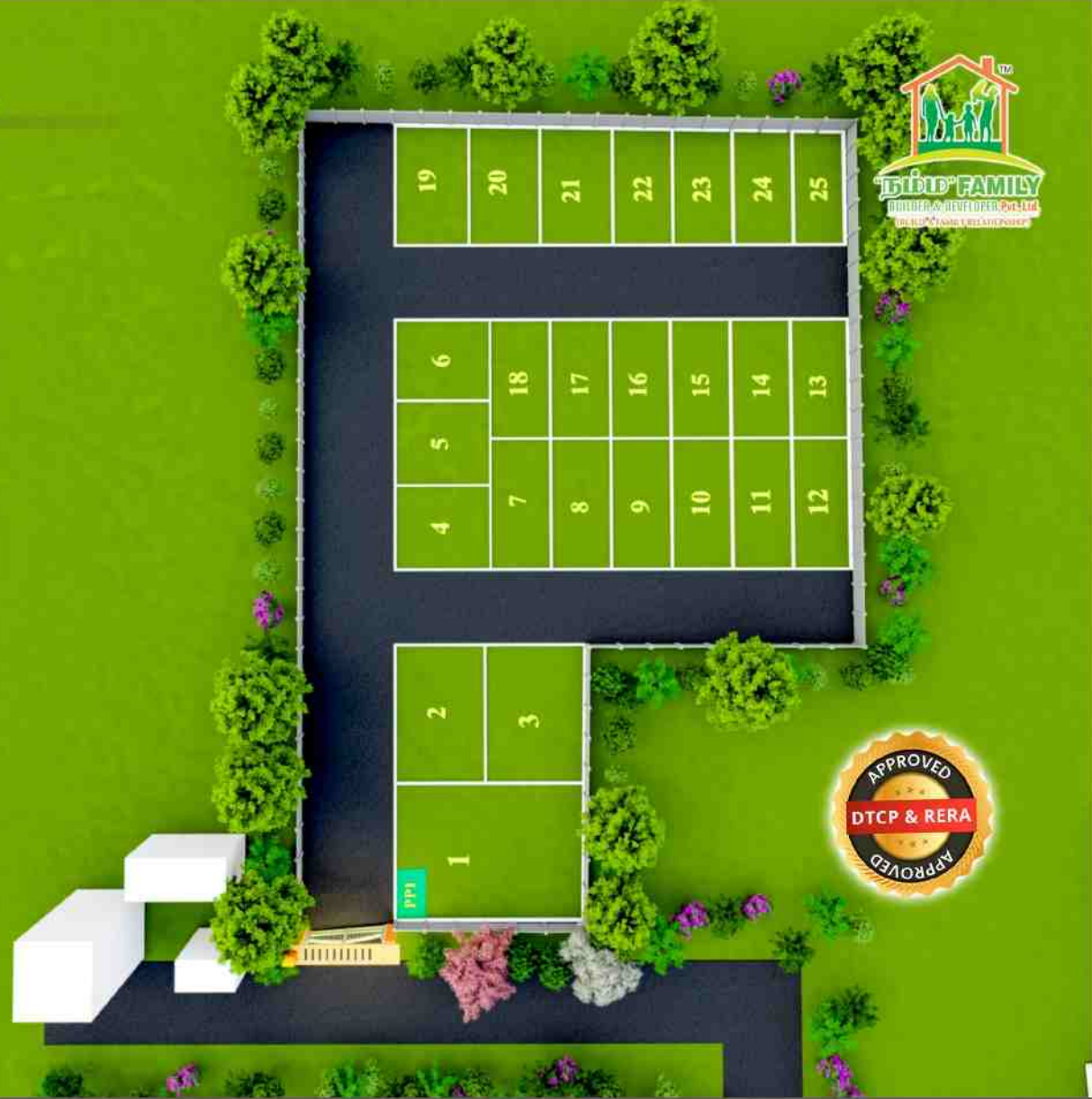

PROJECT CONFIGURATION		
SIZE	UNITS	RANGING
89 CENTS	25 PLOTS	703 - 2462

-  Black Top Roads
-  Street Lights
-  Ready for Construction
-  Avenue Trees
-  Compound Walls

Namma Family Builder & Developer Pvt.Ltd.



NEAR BY COLLEGES

- ✓ 15 Minutes -Jaganath Institute of Technology
- ✓ 28 Minutes -Government College of Architecture & Sculpture
- ✓ 25 Minutes -Dhanalakshmi Srinivasan College of Engi. & Tech.
- ✓ 20 Minutes -AVIT College
- ✓ 20 Minutes -Sai University
- ✓ 8 Minutes -Shri Sathya Sai Medical College & Research Institute
- ✓ 15 Minutes -SSN College of Engineering
- ✓ 20 Minutes -Chettinad Academy of Research and Education
- ✓ 25 Minutes -Hindustan college of Arts & Science
- ✓ 30 Minutes -Sathyabama University

NEAR BY SCHOOLS

- ✓ 10 Minutes -Srivani Vidyalaya Matriculation School
- ✓ 10 Minutes -Bharatha Vidyalaya Matric Higher Secondary School
- ✓ 15 Minutes -Bhuvana Krishna Matric Higher Secondary School
- ✓ 15 Minutes -Evergreen Matric Higher Secondary School
- ✓ 12 Minutes -Sri Chaitanya School
- ✓ 10 Minutes -Gurudeva Nursery & Primary School
- ✓ 25 Minutes -Maamallan Public & Residential CBSE School
- ✓ 12 Minutes -CEE DEE YES D.A.V- Public School
- ✓ 20 Minutes -Velammal New Gen School
- ✓ 25 Minutes -Jaganath Vidyalaya CBSE School

NEARBY ENTERTAINMENTS

- ✓ 20 Minutes -Crocodile Bank Beach
- ✓ 25 Minutes -Kovalam Beach
- ✓ 30 Minutes -MGM Dizze World
- ✓ 20 Minutes -Mahabalipuram Beach & Resort
- ✓ 30 Minutes -Mayajaal Multiplex
- ✓ 25 Minutes -Muttukadu Boat House
- ✓ 25 Minutes -Marina Mall
- ✓ 28Minutes -Vivra Mall
- ✓ 10 Minutes -Arul Muruga Theatre



NEAR BY HOSPITALS

- ✓ 8 Minutes -Shri Sathya Sai Hospital
- ✓ 20 Minutes -Chettinad General Hospital
- ✓ 15 Minutes -Raj Multicare Hospital
- ✓ 15 Minutes -Orchid Children's Hospital
- ✓ 08 Minutes -Rakshith Hospital
- ✓ 10 Minutes -ESK Hospital
- ✓ 15 Minutes -ALPHA Multispeciality Hospital

NEAR BY RESORTS

- Radission Blu Resort
- Bay Treasure Resort
- Tamilnadu Tourism Resort
- Coral Beach Resort
- Silver Sands Beach Resort
- Welcome palm Beach Resort
- Sheraton Grand Resort
- Blue Bay Beach Resort
- Golden Sun Hotel & Beach Resort
- Kaldan Samudhra
- Ideal Beach Resort
- Royal Beach Resort
- Jo Beach Resort
- Ocean Drive Villas
- Intercontinental Resort

Namma Family Builder & Developer Pvt.Ltd.



NEARBY HIGHLIGHT LOCATIONS

- ✓ 8 Minutes - OMR Road
- ✓ 8 Minutes - Thiruporur
- ✓ 20 Minutes - Nemmeli
- ✓ 20 Minutes - ECR
- ✓ 25 Minutes - Pooncheri
- ✓ 30 Minutes - GST Road
- ✓ 30 Minutes - Guduvanchery
- ✓ 45 Minutes - Vandalur
- ✓ 27 Minutes - Chengalpattu
- ✓ 55 Minutes - Oragadam
- ✓ 34 Minutes - Thirukazhukundram
- ✓ 30 Minutes - Mahabalipuram
- ✓ 20 Minutes - Kelambakkam
- ✓ 25 Minutes - Kovalam
- ✓ 29 Minutes - Muthukadu
- ✓ 25 Minutes - Navalur
- ✓ 25 Minutes - Siruseri
- ✓ 50 Minutes - Tambaram
- ✓ 50 Minutes - Thiruvanmiyur

NEARBY GOVERNMENT OFFICES

- ✓ 11 Minutes to Thirupour SRO
- ✓ 10 Minutes to Thiruporur Town Panchayat
- ✓ 10 Minutes to Thiruporur Taluk Office
- ✓ 13 Minutes to Nellikuppam VAO Office
- ✓ 7 Minutes to Thandalam Panchayat Office

GREAT REASONS TO BUY

- ✓ DTCP & RERA Approved
- ✓ High potential for Appreciation due to,
 - ✓ OMR-Kelambakkam bypass
 - ✓ Upcoming Wonderla | Sports Club
 - ✓ Near to One Hub Chennai & Alpha Aviation
 - ✓ Near to Siruseri IT Park



Location Highlights



Shri Sathya Sai
Medical College and
Research
Institute



One Hub Chennai



Thirupurur
Murugan Temple



CEE DEE YES
Apartment

CLOSE TO ALL THAT YOU NEED!!!



SSN College of
Engineering



Radisson Blu Resort



Chettinad College of Engineering



Thirupurur SRO



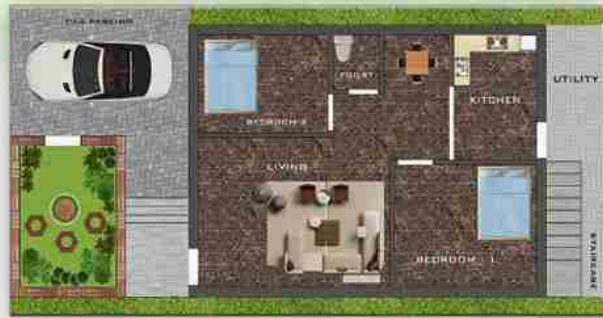

25' X 30'
NORTH FACING



30' X 40'
NORTH FACING



GROUND FLOOR **IRREGULAR SITE** **FIRST FLOOR**

NORTH FACING



30' X 40'
NORTH FACING



*"Make it Simple
But Significant"*

IRREGULAR SITE
NORTH FACING



AREA STATEMENT

Site Area - 1260 sq.ft
Ground Floor - 972 sq.ft
Staircase - 137 sq.ft
Built up Area - 1109 sq.ft

Living - 201.2 sq.ft
Kitchen - 85 sq.ft
Dining - 58.8 sq.ft
Bedroom - 93.6 sq.ft
M.Bedroom - 151.2 sq.ft
Car Parking - 165.3 sq.ft

27' X 45'
EAST FACING



For More Designs Visit

<https://nammfamilybuilder.com/3d-designs/>



WE FOCUS ON DESIGN WITH COMFORT

**GIVE
D YOUR
REAMS**
A SHAPE OF REALITY





GROUND FLOOR



FIRST FLOOR



WE CREATE BEAUTIFUL SPACES...

WE BELIEVE THAT A HOME DEFINES PEOPLE, DEFINES FAMILY



30' X 40'
NORTH FACING

AREA STATEMENT

- Site Area - 1200 sq.ft
- Ground Floor - 934 sq.ft
- First Floor - 952 sq.ft
- Staircase - 240 sq.ft
- Built up Area - 2126 sq.ft

GROUND FLOOR

- Living - 154.7 sq.ft
- Kitchen - 69 sq.ft
- Bedroom 1 - 148.9 sq.ft
- Bedroom 2 - 149.8 sq.ft
- Balcony - 30 sq.ft

FIRST FLOOR

- Living - 154.7 sq.ft
- Kitchen - 69 sq.ft
- Bedroom 1 - 148.9 sq.ft
- Bedroom 2 - 149.8 sq.ft
- Balcony - 30 sq.ft



INTERIORS









CREATIVITY IN EVERY SHOT

A HOME IS NOT A HOME
 WITHOUT INTERIOR DESIGN!

A ROOM SHOULD NEVER ALLOW THE EYE TO SETTLE IN ONE PLACE. IT
 SHOULD SMILE AT YOU AND CREATE FANTASY.







www.nammafamilybuilder.com

CALL US
89 39 22 22 70

Head Office
 No.11 Valli Nagar 1st Street,
 Govindarajapuram, Guduvanchery - 603-202.

Branch Office
 GST ROAD : No.88, Rajaji Nagar,
 Thangappapuram, Guduvanchery-603-202.

Branch Office
 OMR ROAD : No.1/35, OMR Road,
 Kelambakkam, Thiruporur - 603 103



TO KNOW MORE