



Bay Flower Villas

Ninnakarai @ GST





Living with Harmony

With Nature And Life

*Bay Flower Villas - A Premium
Individual Villa Living*



NAMMA FAMILY
GROUP

Our Story

NAMMA FAMILY BUILDER & DEVELOPER was established in 2016 by Mr. Ponnusamy Karthik.A (Founder & Chairman) along with Mr. K.Govindaraj (AGS), Mr. A.Idhayadulla, Mr. T.U.Srikanth, Mr. V.P.Thanigaimalai, and Mr. G.Anand.

What began with one project a year has grown into multiple landmark developments, making us one of the most trusted builders in Guduvanchery, Chennai.

In 2019, we proudly formed the NFBF Group, Group of Business constitute of 260+ Employees | 1000+ Labourers and in 2020, we officially registered our company logo, marking a new milestone in our journey.

www.nammafamilybuilder.com

History & Milestones

2016	10+ Employees NFBD Established by Mr. Ponnusamy Karthik.A, Along with Mr. K. Govindaraj (AGS), Mr. A. Idhayadulla, Mr. T. U. Srikanth, Mr. V. P. Thanigaimalai, Mr. G. Anand
2017	20+ Employees Started Resale Plots Sale in Guduvanchery
2018	40+ Employees Expert in plots Resale & Expanded Business All over India. Started analysis for Group of Business.
2019	30+ Employees 1st Branch in Guduvanchery As a Pioneer In Plot Resale, Expanded Real Estate Business All over Tamil Nadu
2020	60+ Employees 2nd Branch in Guduvanchery Acquired Private Limited Certification Started projects all Over India – Group of Business
2021	75+ Employees Extended our service in Layout sales all over India. Import & Export, Business Development, Investor, Real Estate & Construction

2022	90+ Employees 3rd Branch in Kelambakkam Excelling in all Business Operations with 800+ employees Worldwide. ISO 9001 : 2015 Certification Successfully Acquired.
2023	190+ Employees & 800+ Labourers Launched Premium Projects, pitched into different locations Tie up with corporate establishment
2024	240+ Employees & 900+ Labourers Becomes President of the Villupuram Tamil Nadu Athletic Association
2025	260+ Employees & 1000+ Labourers Recognized for impactful Social Welfare Activities across Tamil Nadu Chairman honored with Multiple State & National Awards

Group of Business

NAMMA FAMILY GROUP

REAL ESTATE & CONSTRUCTION



Resale Plots, Layout Plots, Commercial Plots, Industrial Plots in Real Estate Industry across Tamil Nadu, Kerala & Karnataka. (Plots, Individual House, Bungalows, Resorts, Farm Houses, Estates)

IMPORT & EXPORT

Namma Family Pollachi Ilaneer is one of the leading exporters and suppliers in India, serving the global market with premium-quality products that meet international standards.



The company can supply up to 25 lakh tender coconuts per day worldwide, ensuring quality, reliable service, and on-time delivery. We are actively planning and expanding to supply 25 lakh nuts globally, driven by a structured business strategy and strong operational capabilities.

Farm Locations: Tamil Nadu (Pollachi, Coimbatore), Karnataka, Kerala, and Thailand. We export high-quality tender coconuts to various countries, including the USA, UK, Dubai, Saudi Arabia, and across India, while strictly adhering to international standards.

Currently, our export business is registered as Namma Family International Company. We serve 10,000+ clients across the export sector and maintain a strong client database to support both current operations and future projects.

BUSINESS DEVELOPMENT



1. Completed Projects 50+
2. Ongoing Projects in Ooty, Yercaud & Wayanad (Kerala)
3. Planned 110+ Projects Across all business all over India (TN, Kerala, Karnataka)

Departments



BOARD OF DIRECTORS
SALES & MARKETING
CADD DEPARTMENT
DIGITAL MARKETING
REVENUE & LEGAL
VISUAL CREATOR
GRAPHIC DESIGN
SOCIAL MEDIA
CINEMATOGRAPHER
PRODUCT SOURCING
PROMOTIONAL WING
ACCOUNTING & FINANCE
OPERATIONS MANAGEMENT
HUMAN RESOURCES
RESEARCH & DEVELOPMENT
PURCHASE DEPARTMENT
ENVIRONMENTAL TEAM
MARKETING MANAGEMENT
BACK-END MANAGEMENT
CRM DEPARTMENT
GISTAK TEAM

GENERAL MANAGEMENT
PROJECT DIRECTORS
PROJECT ADMINISTRATIVE
IT DEPARTMENT & LOGISTICS
DISTRIBUTION DEPARTMENT
TESTING & COMPLIANCE
TRANSPORT DEPARTMENT
PLANNING & MANAGEMENT
PROJECT DEVELOPMENT
PROJECT ANALYSIS
PRODUCTION & PURCHASE
PROJECT & PRODUCT MAINTENANCE DEPARTMENT
QUALITY ASSURANCE
LOAN PROCESSING
MANUFACTURING & PACKAGE DEPARTMENT
CHAUFFEUR
CLIENT OPERATIONS MANAGEMENT
PRODUCT PRESENTATION & DATA MANAGEMENT
OPERATIONS COORDINATORS
SEYAL TRUST
REGISTRATION DEPARTMENT
PR DEPARTMENT

NFBD Revenue Document Verification Process



Self Employed Client Proof

- ✓ PAN Card & Aadhaar Card
- ✓ IT Papers (Last 3 Years) & Business Photos Proof
- ✓ Current & Savings Account Statement (1 year)
- ✓ Passport Size Photos (2) & Stamp Size Photo (1)
- ✓ Processing Fees Cheque (Depends On The Loan Amount)
- ✓ Company Registered Certificate Copy

Salaried Client Proof

- ✓ PAN Card & Aadhaar Card
- ✓ Office ID Card & Offer Letter Copy
- ✓ Latest 3 Month Pay Slip & Latest 2 Years Form 16
- ✓ Salary Bank Statement For Last 6 Months
- ✓ Passport Size Photos (2) & Stamp Size Photo (1)
- ✓ Processing Fees Cheque (Depends On The Loan Amount)



Bay Flower Villas

2 BHK (or) 3BHK Villas

Step into Bay of Flower a signature villa address crafted in harmony with nature. Thoughtfully designed homes, lush green surroundings, and refined amenities come together seamlessly. Here, modern comfort blends effortlessly with timeless elegance.

@Ninnakarai

17

Overall

11

Available

DTCP NO : 301 / 2024

Potable Water / Private Leisure / Service & Utility





Layout Sketch

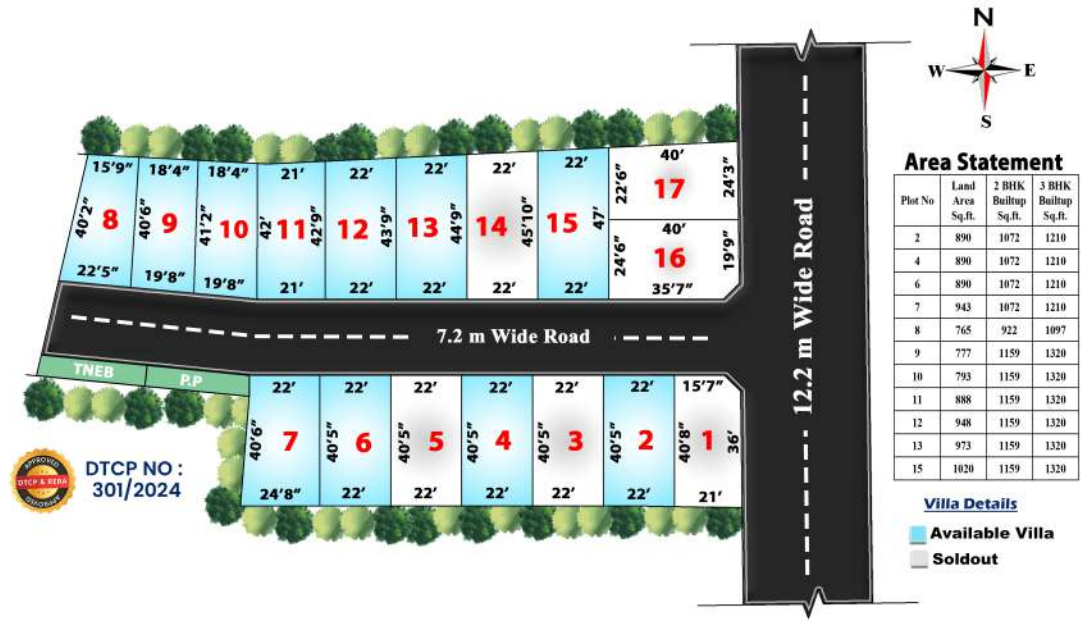

Area Statement

Plot No	Land Area Sq.ft.	2 BHK Builtup Sq.ft.	3 BHK Builtup Sq.ft.
2	890	1072	1210
4	890	1072	1210
6	890	1072	1210
7	943	1072	1210
8	765	922	1097
9	777	1159	1320
10	793	1159	1320
11	888	1159	1320
12	948	1159	1320
13	973	1159	1320
15	1020	1159	1320

Villa Details

- Available Villa
- Soldout



Ground Floor



First Floor - 2BHK



First Floor-3BHK

2,4,6,7
Plot Nos

1072 Sq.ft.
Built up Area For 2BHK

1210 Sq.ft.
Built up Area For 3BHK



*"A home that
lets life bloom."*

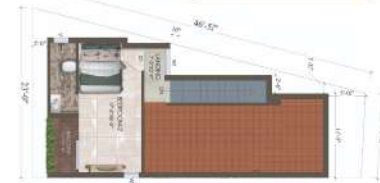

08
Plot No

922 Sq.ft.
Built up Area For 2BHK

1097 Sq.ft.
Built up Area For 3BHK



Ground Floor

9,10,11,12,13,15

Plot Nos



First Floor - 2BHK



First Floor - 3BHK

1159 Sq.ft.

Built up Area For 2BHK

1320 Sq.ft.

Built up Area For 3BHK





NAMMA FAMILY
GROUP

"A gated community where elegance meets nature."



Specification

Structure :	RCC framed structure with Fe550 Steel and M20 grade concrete.
Walls :	Internal 115 mm in Ratio [CM 1:8] and External 230 mm in Ratio [CM 1:7] cement brick walls with smooth plaster finish.
Flooring & tiles:	Vitrified Tiles [Somany For Equivalent to That] [4 X 2 or 2 X 2] Customized tiles for living and bedrooms, [1 X 1] anti-skid tiles For Toilet & Balcony Flooring, 2X2 Or 2X1 [Customized] Ceramic Tiles Walls Up to [7 Feet] in toilets [2 X 1] ceramic tiles Up to 2 Feet Height From Kitchen Top
Staircase:	Granite flooring.
Doors:	Teak wood main door with Brass fittings and WPC internal doors with Mica finish.
Windows:	UPVC windows with plain glass.
Railings & Safety:	SS Handrails and MS safety grills for windows and main door.
Painting:	Asian paints - Interior : 1Coat Primer + 2Coat Tractor Emulsion paint for Ceiling +2 Coat Putty Over that 2Coat Emulsion paint With Smooth Finish Exterior: 1Coat Primer + 2Coat Apex Ultima paint.

Plumbing & Sanitary:	EWC & Parryware or Equivalent sanitary fittings with 2 In 1 wall mixer and White wash basin with SS Or Equivalent CP fittings.
Electrical:	Havells Wires or Equivalent to That Concealed Copper wiring with modular switches .
Kitchen:	Black granite countertop with 1.5 X 2 Feet stainless steel sink.
Water Supply:	1000 litres PVC water tank for each house.
Terrace:	Natural red tile flooring with proper slope.
Compound Wall:	Individual compound wall with 5 Feet Height and 10 X 5 MS main gate.
Borewell:	Separate borewell with motor, 15000 litres septic tank, and 3-phase EB connection for each house.

NOTE :

1. We Will Provide Proper Rainwater canal on Two Side Of The Road
2. Proper Cement or Thar or Paving Block Road Will Be Done While Hand Over All The Villas
3. No Maintenance Charge And No Hidden Charges

Location



1. SRM University
2. Zoho Corporation
3. SRM Public School
4. Intimate Fashions India Pvt. Ltd.
5. Polyhose India Pvt. Ltd. - Unit IV
6. Apollo Arts and Science College
7. Ela Green School (IB Board)
8. ARM College of Engineering & Technology
9. State Institute of Rural Development Tamil Nadu
10. Ford India Pvt. Ltd.
11. Velammal Vidhyashram, Maraimalai Nagar
12. Velammal Vidhyashram, Guduvanchery

Live the grand life
in a lovely
Neighbourhood

2 mins From Maraimalai Nagar

NAMMA FAMILY GROUP

Email : www.nammafamilybuilder.com

Contact Us : 89 39 22 22 70

Corporate Office :
No.1/41, OMR Road,
Kelambakkam - 603 103

Head Office :
No.11, Valli Nagar 1st Street,
Govindarajapuram,
Guduvanchery - 603 202

Branch Office :
No.88, Rajaji Nagar,
Thangappapuram,
Guduvanchery - 603 202



Website



Linkedin



Facebook



Instagram



You Tube



Telegram



X.com



www.nammafamilybuilder.com